

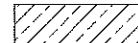



G:\ENGINEERING\2015\1501546-15 180-A-22 INTERCHANGE\DWG\1501546-15 180-A-22\REVISIONS OF CONSTRUCTION 10/15/15.dwg

LEGEND

-  CONSTRUCTION THIS PHASE
-  REMOVAL OF EXISTING PAVEMENT

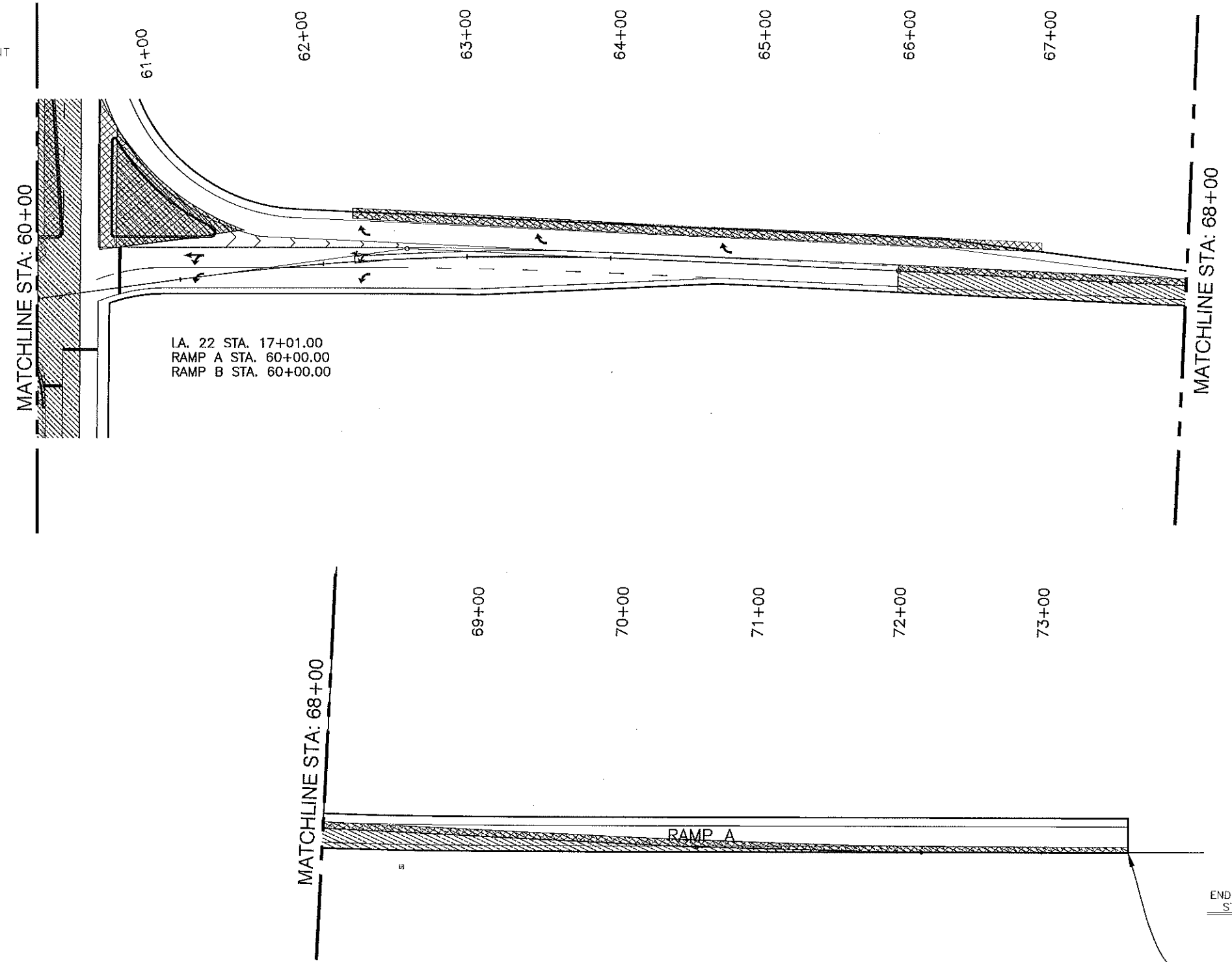

90% PRELIMINARY
"NOT FOR BIDDING, CONSTRUCTION,
PERMITTING OR RECORDATION"

SHEET NUMBER		43	
DESIGNED		JWB	
CHECKED		JWB	
DETAILS		RHK	
PROJECT		JWB	
DATE		DEC. 2018	
SHEET		8 OF 11	
PARISH		ST. TAMMANY	
FEDERAL PROJECT		H.011721	
STATE PROJECT		H.011721	
REVISION DESCRIPTION		BY	
NO.		DATE	
			
<p>SUGGESTED SEQUENCE OF CONSTRUCTION PHASE 2 (SHEET 2 OF 5) U.S. 190/LA. HWY 22 IMPROVEMENTS</p>			
<p>J.V. BURKES & ASSOCIATES</p>			



C:\ENGINEERING\2015\2015121514-US 160-LA 22 INTERCHANGE\DWG\22 SEQUENCE OF CONSTRUCTION 80X.dwg

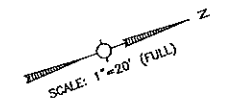
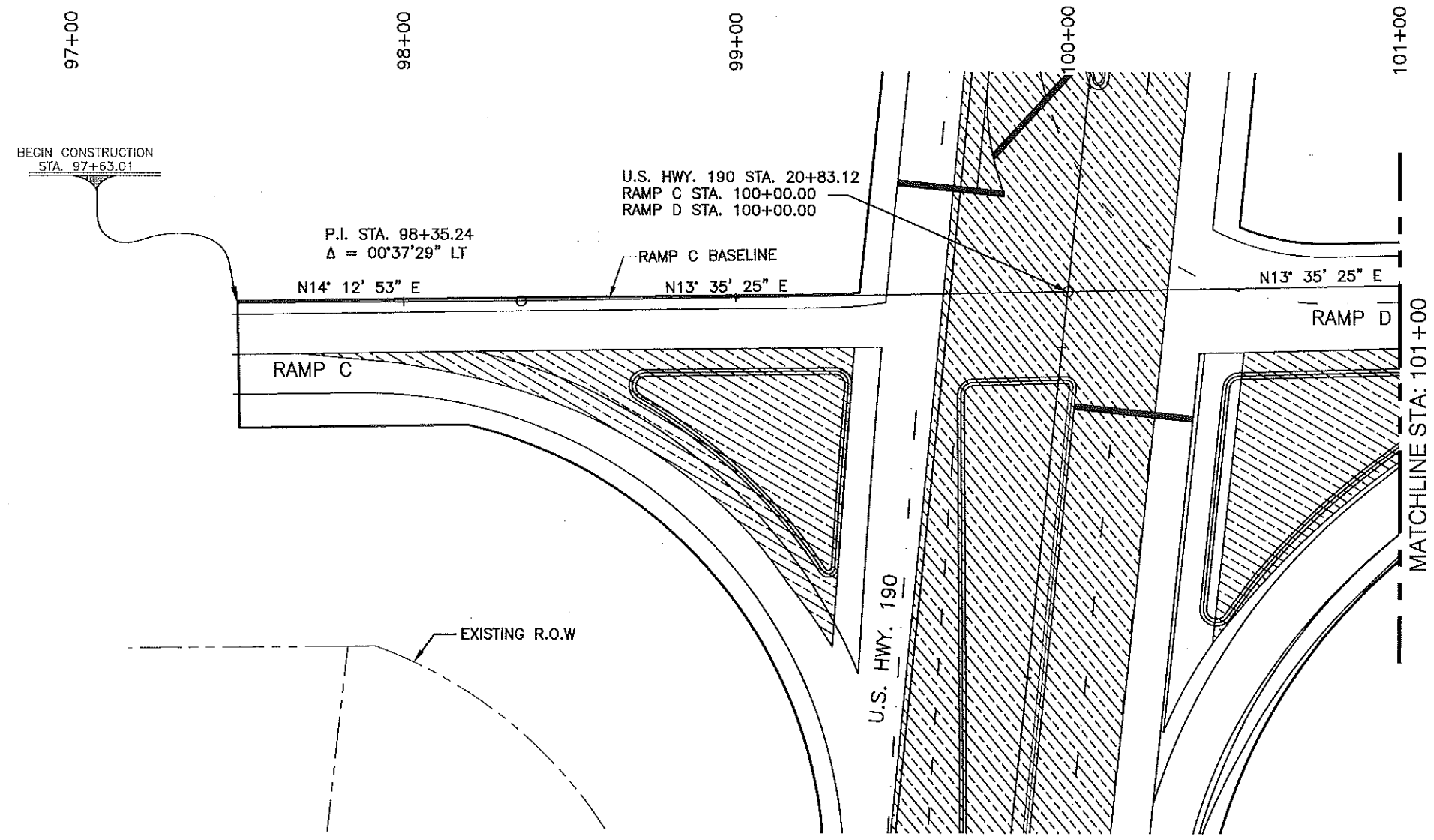

90% PRELIMINARY

"NOT FOR BIDDING, CONSTRUCTION, PERMITTING OR RECORDATION"

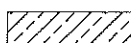

LEGEND

	CONSTRUCTION THIS PHASE
	REMOVAL OF EXISTING PAVEMENT

SHEET NUMBER		45	
ST. TAMMANY		ST. TAMMANY	
PARISH		PARISH	
FEDERAL PROJECT		FEDERAL PROJECT	
STATE PROJECT		STATE PROJECT	
DESIGNED		DEC. 2018	
CHECKED		10 OF 11	
DATE		BY	
NO.		DATE	
REVISION DESCRIPTION		DATE	
			
SUGGESTED SEQUENCE OF CONSTRUCTION PHASE 2 (SHEET 4 OF 5) U.S. 190/LA. HWY 22 IMPROVEMENTS			
			
J.V. BURKES & ASSOCIATES			

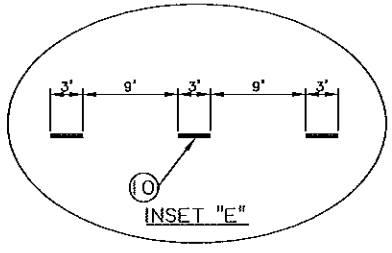
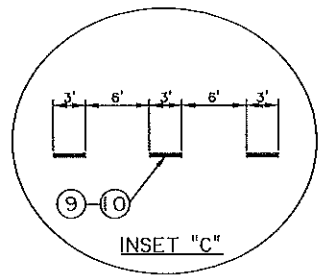
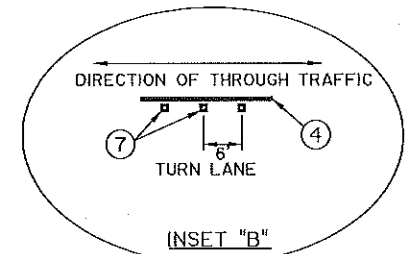
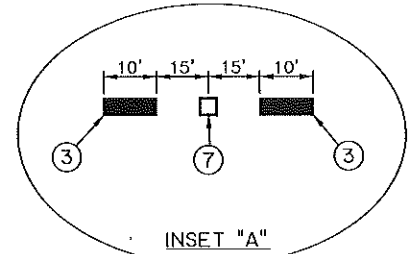

- LEGEND
- 1 PERMANENT WHITE PLASTIC PAVEMENT STRIPING (SOLID LINE) (4" WIDTH)
 - 2 PERMANENT YELLOW PLASTIC PAVEMENT STRIPING (SOLID LINE) (4" WIDTH)
 - 3 PERMANENT YELLOW PLASTIC PAVEMENT STRIPING (DOUBLE CENTER STRIPE) (4" WIDTH)
 - 4 PERMANENT WHITE PLASTIC PAVEMENT STRIPING (SOLID LINE) (6" WIDTH)
 - 5 PERMANENT WHITE PLASTIC PAVEMENT STRIPING (TYPE B DOTTED STRIPE) (6" WIDTH)
 - 6 PERMANENT WHITE PLASTIC PAVEMENT STRIPING (24" WIDTH)
 - 7 PERMANENT YELLOW PLASTIC PAVEMENT STRIPING (24" WIDTH)
 - 8 PERMANENT PLASTIC PAVEMENT LEGENDS AND SYMBOLS
 - 9 REFLECTORIZED RAISED PAVEMENT MARKERS
 - 10 PERMANENT WHITE PLASTIC PAVEMENT STRIPING (TYPE B DOTTED STRIPE) (4" WIDTH)

PAVEMENT MARKING SHALL COMPLY WITH STANDARD PLAN PM-01 AND PM-05 UNLESS DIRECTED OTHERWISE BY THE PROJECT ENGINEER

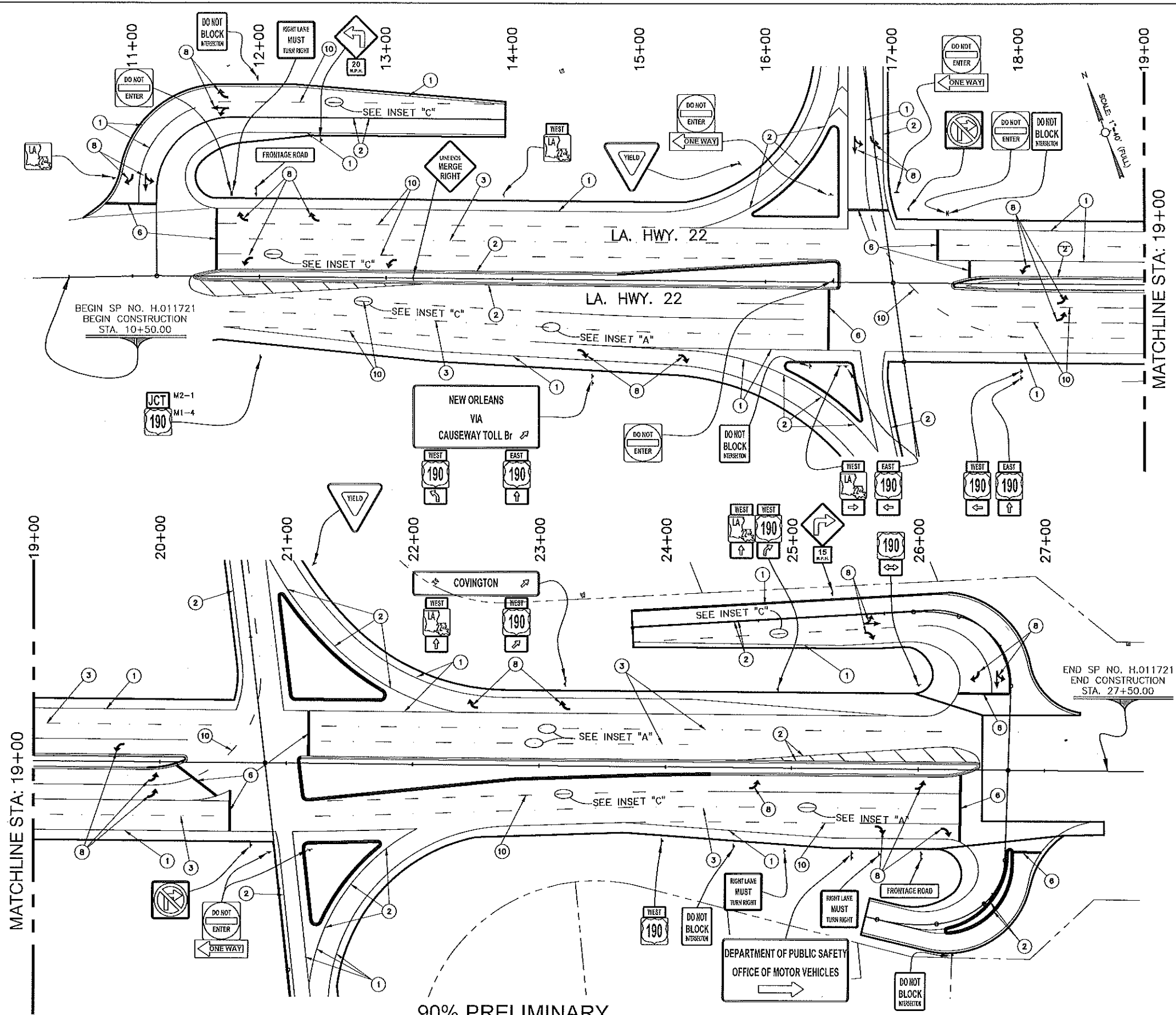

D:\ENGINEERING\2015\20150114-15-18-LA-22_INTERCHANGE\DWG\006.mxd 150-22_SCHWABE_and_STRIPING-006.dwg

SHEET NUMBER		47	
PARISH		ST. TAMMANY	
FEDERAL PROJECT		H.011721	
STATE PROJECT		H.011721	
DESIGNED	CHECKED	DATE	BY
JWB	JWB	DEC. 2018	
DETAILED	CHECKED	DATE	BY
JWB	JWB	1 OF 5	
REVISION DESCRIPTION			
NO.			
DATE			
U.S. 190/LA. HWY. 22 & FRONTAGE ROADS A, C & D PERMANENT SIGNAGE & STRIPING PLAN			
U.S. 190/LA. HWY 22 IMPROVEMENTS			
J.V. BURKES & ASSOCIATES			

90% PRELIMINARY
 "NOT FOR BIDDING, CONSTRUCTION, PERMITTING OR RECORDATION"

SHEET NUMBER		49	
DESIGNED	JWB	ST. TAMMANY	
CHECKED	JWB	FEDERAL PROJECT	H.011721
DATE	DEC. 2018	STATE PROJECT	H.011721
NO.	5 OF 5		
BY			
REVISION DESCRIPTION			

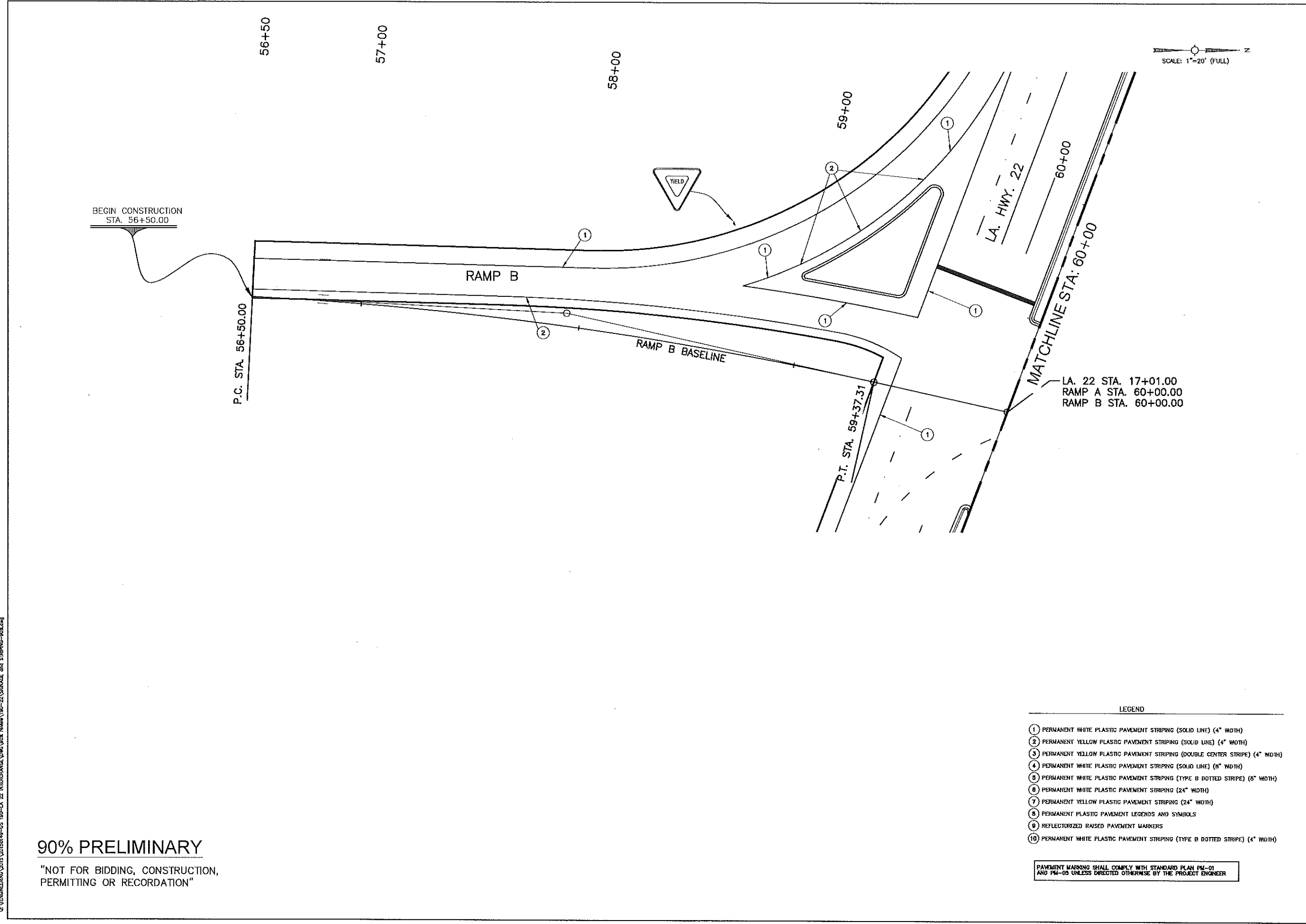

90% PRELIMINARY
 "NOT FOR BIDDING, CONSTRUCTION,
 PERMITTING OR RECORDATION"



- LEGEND
- ① PERMANENT WHITE PLASTIC PAVEMENT STRIPING (SOLID LINE) (4" WIDTH)
 - ② PERMANENT YELLOW PLASTIC PAVEMENT STRIPING (SOLID LINE) (4" WIDTH)
 - ③ PERMANENT YELLOW PLASTIC PAVEMENT STRIPING (DOUBLE CENTER STRIPE) (4" WIDTH)
 - ④ PERMANENT WHITE PLASTIC PAVEMENT STRIPING (SOLID LINE) (8" WIDTH)
 - ⑤ PERMANENT WHITE PLASTIC PAVEMENT STRIPING (TYPE B DOTTED STRIPE) (8" WIDTH)
 - ⑥ PERMANENT WHITE PLASTIC PAVEMENT STRIPING (24" WIDTH)
 - ⑦ PERMANENT YELLOW PLASTIC PAVEMENT STRIPING (24" WIDTH)
 - ⑧ PERMANENT PLASTIC PAVEMENT LEGENDS AND SYMBOLS
 - ⑨ REFLECTORIZED RAISED PAVEMENT MARKERS
 - ⑩ PERMANENT WHITE PLASTIC PAVEMENT STRIPING (TYPE B DOTTED STRIPE) (4" WIDTH)

PAVEMENT MARKING SHALL COMPLY WITH STANDARD PLAN PM-01 AND PM-03 UNLESS DIRECTED OTHERWISE BY THE PROJECT ENGINEER

G:\VENDOR\2015\2016\149-US 100-LA 22 INTERCHANGE\JOB\JOB REV\150-22\STRIPING and STRIPING-903.dwg

RAMP B
PERMANENT SIGNAGE
& STRIPING PLAN

U.S. 190/LA. HWY 22 IMPROVEMENTS

J.V. BURKES & ASSOCIATES

90% PRELIMINARY
 "NOT FOR BIDDING, CONSTRUCTION,
 PERMITTING OR RECORDATION"

C:\JANUARY\2015\201504-15-180-A-22 INTERCHANGE.DWG DATE: 1/16/15 2:13:04 PM AND STRIPING-504.dwg

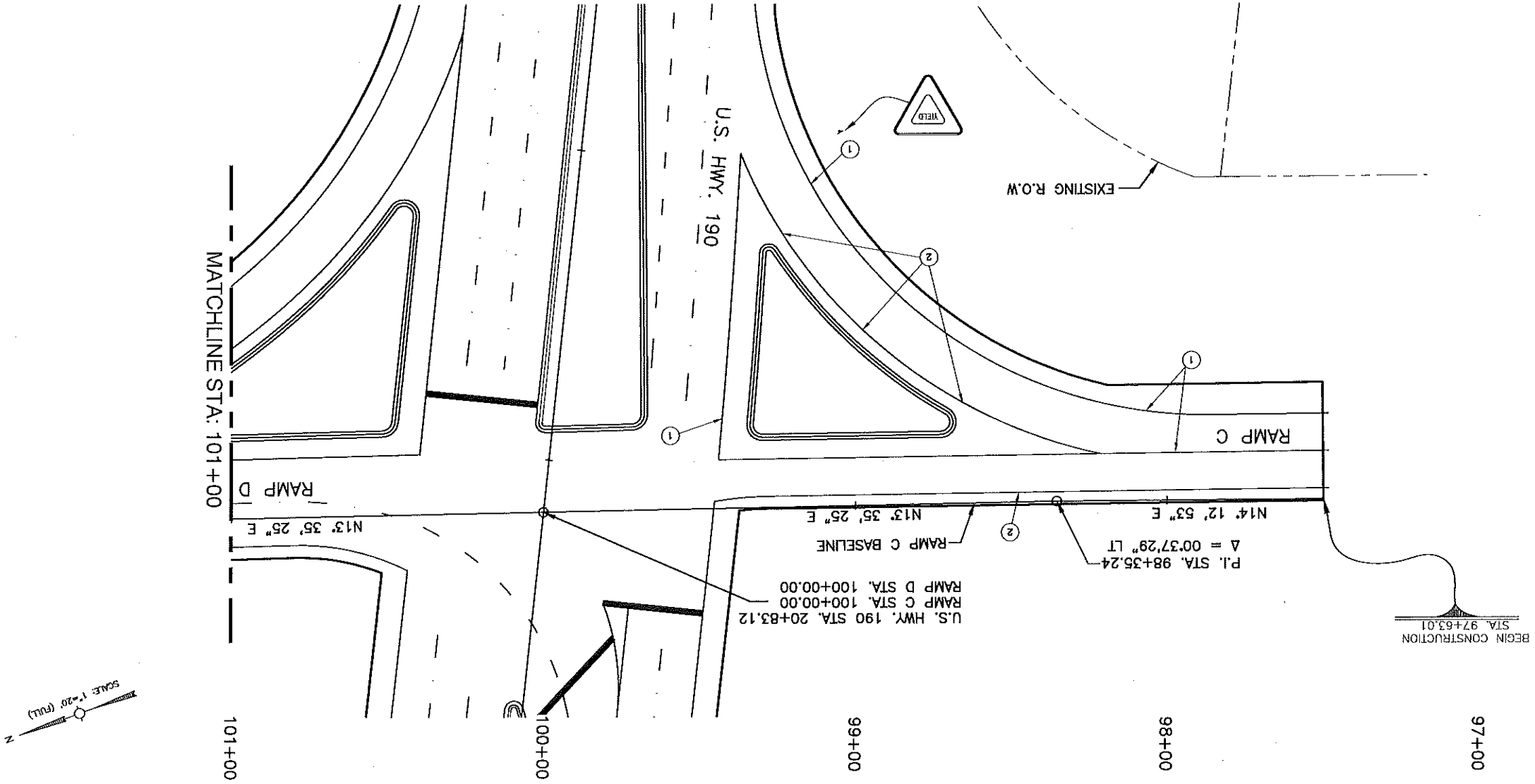

- LEGEND
- ① PERMANENT WHITE PLASTIC PAVEMENT STRIPING (SOLID LINE) (4" WIDTH)
 - ② PERMANENT YELLOW PLASTIC PAVEMENT STRIPING (SOLID LINE) (4" WIDTH)
 - ③ PERMANENT YELLOW PLASTIC PAVEMENT STRIPING (DOUBLE CENTER STRIPS) (4" WIDTH)
 - ④ PERMANENT WHITE PLASTIC PAVEMENT STRIPING (SOLID LINE) (6" WIDTH)
 - ⑤ PERMANENT WHITE PLASTIC PAVEMENT STRIPING (TYPE B DOTTED STRIPS) (6" WIDTH)
 - ⑥ PERMANENT WHITE PLASTIC PAVEMENT STRIPING (24" WIDTH)
 - ⑦ PERMANENT YELLOW PLASTIC PAVEMENT STRIPING (24" WIDTH)
 - ⑧ PERMANENT PLASTIC PAVEMENT LEGENDS AND SYMBOLS
 - ⑨ REFLECTORIZED RAISED PAVEMENT MARKERS
 - ⑩ PERMANENT WHITE PLASTIC PAVEMENT STRIPING (TYPE B DOTTED STRIPS) (4" WIDTH)

PAVEMENT MARKING SHALL COMPLY WITH STANDARD PLAN PM-01 AND PM-02 UNLESS DIRECTED OTHERWISE BY THE PROJECT ENGINEER.

SCALE: 1"=20' (FULL)

	<p>RAMP C PERMANENT SIGNAGE & STRIPING PLAN</p> <p>U.S. 190/1A, HWY 22 IMPROVEMENTS</p>	
NO.	DATE	
BY	REVISION DESCRIPTION	
DESIGNED JMB	CHECKED JMB	PARISH ST. TAMMANY
DRAWN JMB	CHECKED JMB	PROJECT H.011721
DATE 4 OF 5	DATE DEC. 2018	STATE H.011721
SHEET NUMBER		50

G:\ENGINEERING\2015\20150414-15-100-LA-22 INTERCHANGE\DWG\190-22 SIGNAGE and STRIPING-001.dwg

90% PRELIMINARY

"NOT FOR BIDDING, CONSTRUCTION,
PERMITTING OR RECORDATION"

U.S. HWY. 190 STA. 20+83.12
RAMP C STA. 100+00.00
RAMP D STA. 100+00.00

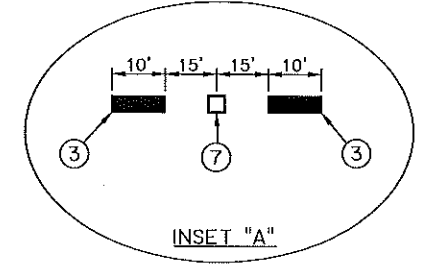
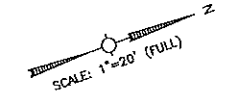
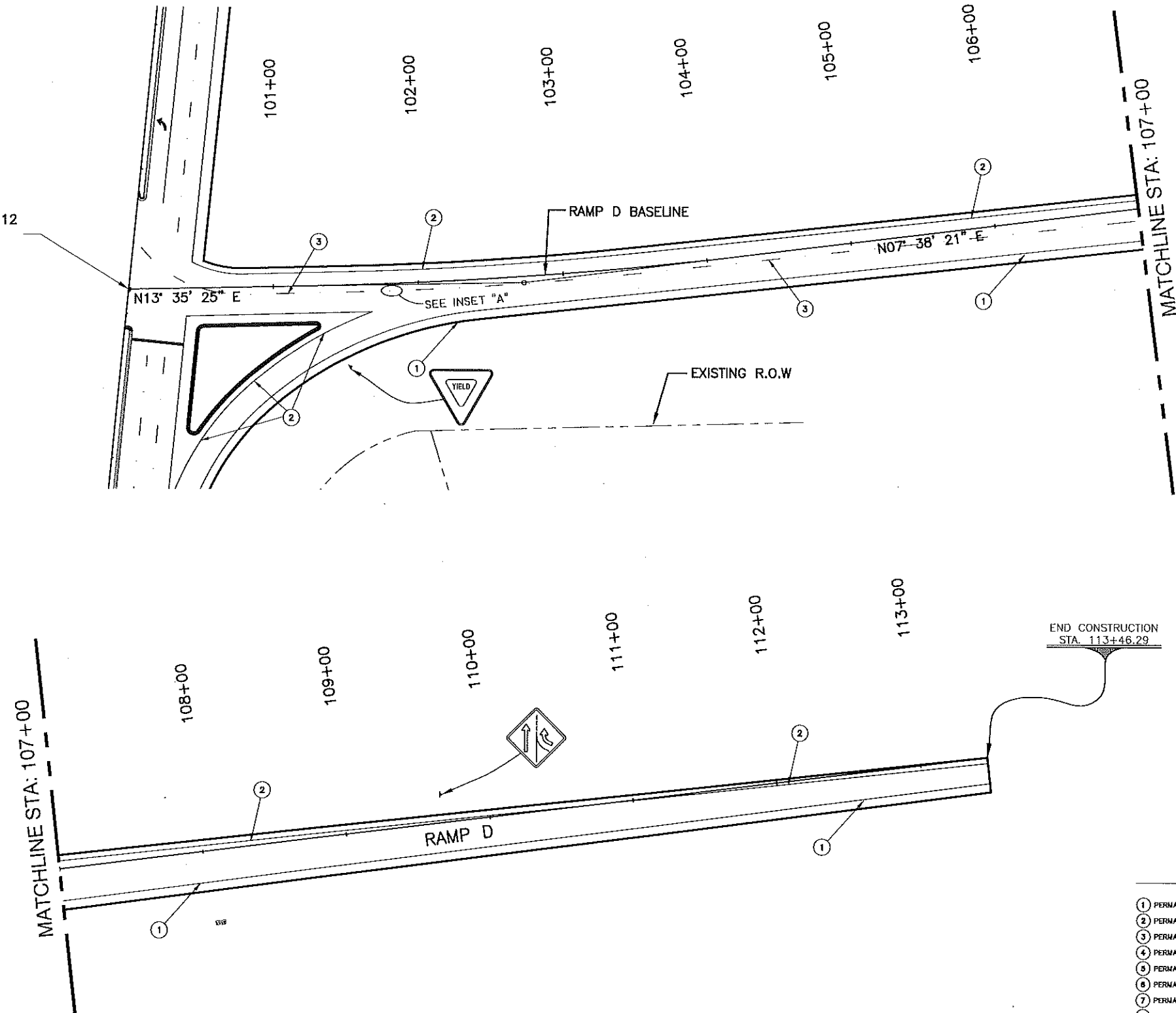

- LEGEND**
- ① PERMANENT WHITE PLASTIC PAVEMENT STRIPING (SOLID LINE) (4" WIDTH)
 - ② PERMANENT YELLOW PLASTIC PAVEMENT STRIPING (SOLID LINE) (4" WIDTH)
 - ③ PERMANENT YELLOW PLASTIC PAVEMENT STRIPING (DOUBLE CENTER STRIPE) (4" WIDTH)
 - ④ PERMANENT WHITE PLASTIC PAVEMENT STRIPING (SOLID LINE) (8" WIDTH)
 - ⑤ PERMANENT WHITE PLASTIC PAVEMENT STRIPING (TYPE B DOTTED STRIPE) (8" WIDTH)
 - ⑥ PERMANENT WHITE PLASTIC PAVEMENT STRIPING (24" WIDTH)
 - ⑦ PERMANENT YELLOW PLASTIC PAVEMENT STRIPING (24" WIDTH)
 - ⑧ PERMANENT PLASTIC PAVEMENT LEGENDS AND SYMBOLS
 - ⑨ REFLECTORIZED RAISED PAVEMENT MARKERS
 - ⑩ PERMANENT WHITE PLASTIC PAVEMENT STRIPING (TYPE B DOTTED STRIPE) (4" WIDTH)

PAVEMENT MARKING SHALL COMPLY WITH STANDARD PLAN PM-01 AND PM-05 UNLESS DIRECTED OTHERWISE BY THE PROJECT ENGINEER

SHEET NUMBER	51	ST. TAMMANY	PARISH PROJECT	PERSONAL PROJECT	STATE PROJECT
DESIGNED	JWB	CHECKED	JWB	DATE	DEC. 2018
DRAWN	JWB	CHECKED	JWB	DATE	5 OF 5
NO.		DATE		BY	
REVISION DESCRIPTION					
RAMP D PERMANENT SIGNAGE & STRIPING PLAN					
U.S. 190/LA. HWY 22 IMPROVEMENTS					
J.V. BURKES & ASSOCIATES					

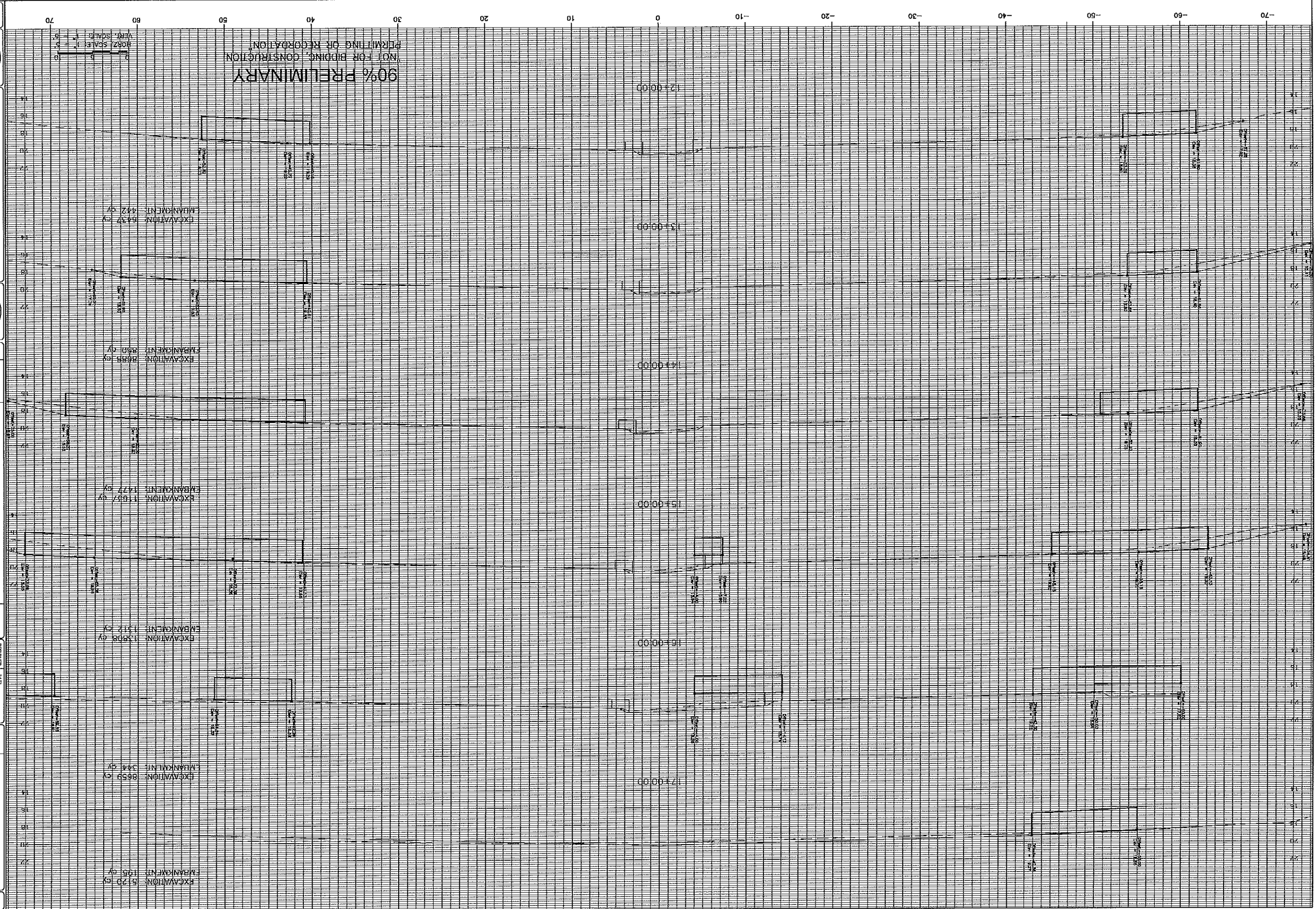

CROSS SECTION SHEETS
 LA. HWY. 22/US. HWY. 190
 U.S. 190/LA. HWY 22 IMPROVEMENTS



NO.	DATE	REVISION DESCRIPTION

DESIGNED	CHECKED	DATE	SHEET
JVB	JVB	DEC. 2011	1 OF 11

PARISH	ST. TAMMANY
SECTION	H.011721
STATE PROJECT	H.011721

SHEET NUMBER
 401