

LEGEND FOR PROPOSED WORK

- = PROPOSED LOOP DETECTOR
- = PROPOSED DROP INLET
- = PROPOSED DRAINAGE FLOW
- = PROPOSED DRAIN LINE
- = PROPOSED SEWER LINE
- = PROPOSED WATER LINE
- = PROPOSED GAS LINE
- = PROPOSED ELECTRIC
- = PROPOSED 6" CURB AND GUTTER
- = PROPOSED GRADE
- = PROPOSED TOP OF CURB
PROPOSED BOTTOM OF CURB
- = PROPOSED GREENSPACE
- = PROPOSED BUILDING TIE

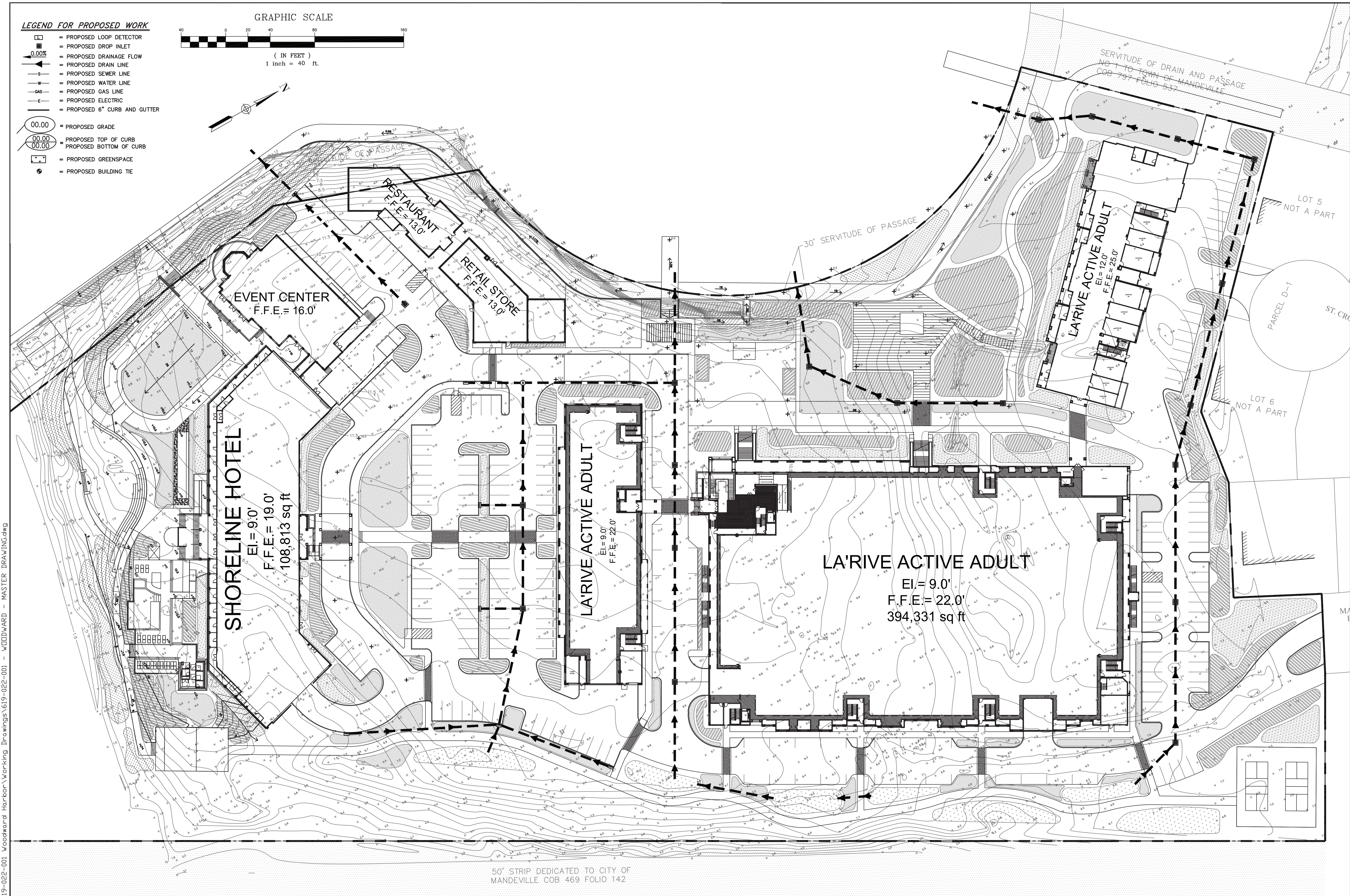
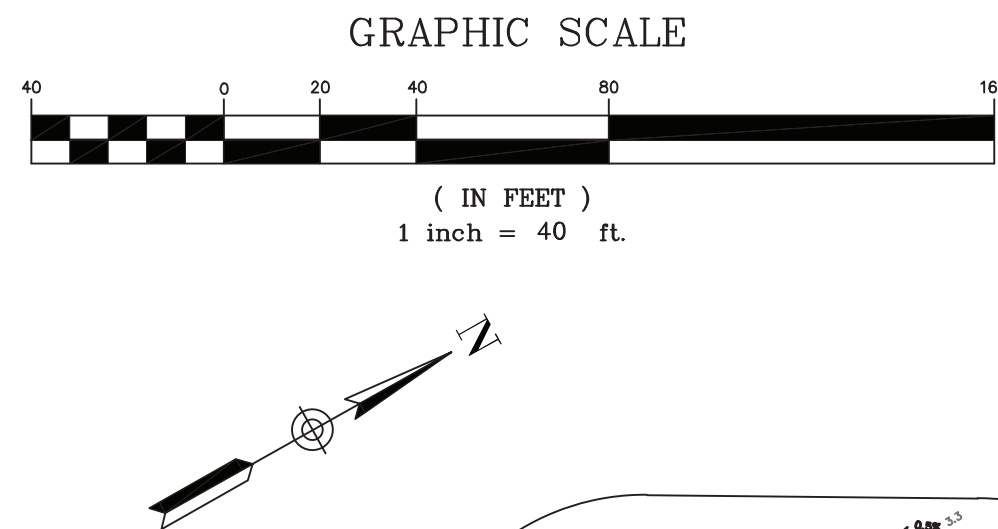

I:\CAD\619-022-001 Woodward Harbor\Working Drawings\619-022-001 - WOODWARD - MASTER DRAWING.dwg

50' STRIP DEDICATED TO CITY OF
MANDEVILLE COB 469 FOLIO 142



RICHARD C. LAMBERT
CONSULTANTS, L.L.C.

900 W. Causeway Approach
Mandeville, LA 70471
985-727-4440
Fax: 985-727-4447

DESIGNED	FJZ
CHECKED	FJZ
DETAILED	FJZ
CHECKED	FJZ
DATE	04/1/22
SHEET	

NO.	DATE	REVISION DESCRIPTION	BY

DRAINAGE PLAN
MARINER'S VILLAGE

Project Number:
RCLC No: 721-05

SCHEMATIC DESIGN
NOT FOR CONSTRUCTION
06/24/2022
RCL CONSULTANTS, LLC
FRANZ J. ZEMER, P.E.
Lic. License No. 28232
THIS DOCUMENT IS NOT TO BE USED FOR
BIDDING OR CONSTRUCTION

Sheet Number: